



HOTEL

THE GRAND

AMSTERDAM

Depuis 1578





Sofitel Legend The Grand Amsterdam caters for all manner of functions, from discreet board meetings to lavish banquets or weddings. We provide banqueting facilities in one of the most sought-after properties in the city center of Amsterdam. Offering premier conference facilities and the InspiredMeetings™ concept, which combines the latest conference technology with a passion for excellence.

Former City Hall

Sofitel Legend The Grand Amsterdam boasts no fewer than 19 meeting rooms and banqueting halls in total (covering 1400m²/15.070ft²), five of which are listed as historical monuments and were taken into use when The Grand served as city hall: the Council Chamber, the Mayor's and Aldermen's Chamber, the St. Cecilia and the beautiful First Class Wedding Chamber. All with a different magnifique story. These five rooms all have natural daylight and canal/garden view. Perfect for any kind of meeting and personalized event. The hotel is a true blend of French elegance and the traditional Amsterdam School Style.

Princenhof

The Princenhof holds 14 contemporary meeting rooms. All equipped with state-of-the-art audio visual facilities, such as a remote touch screen system to monitor the rooms, Wi-Fi, video conferencing for up to 18 people and a video projector.

Unique and tailor-made banqueting

Dedicated to your event, the InspiredMeetings™ planners are here to assist you plan your event to the smallest details to ensure you enjoy a seamless service and stress-free experience.

Whether you are organizing a board meeting or a private dinner, we will work with you and the Executive Chef to create a menu that suits you.

Our Michelin star Restaurant Bridges also features an exclusive dining room which can accommodate up to 12 guests. Flooded with natural daylight and with pleasant views of the Viothèque and the historic canal.

Magnifique facilities

Located between two historic canals in the heart of the city, Sofitel Legend The Grand Amsterdam boasts a rich history. Furnished with French elegance and grandeur, the hotel blends sleek design with five star facilities.

The hotel, comprising 177 rooms including 52 suites with Butler Service, is enhanced by a multiple award-winning luxury hotel SoSPA. Offering a sophisticated but relaxed welcome, the hotel features the popular Restaurant Bridges*, inspired by Ron Blaauw, a Parisian themed bistro and a typical Dutch brown bar, ideal for a drink with your colleagues after your meeting.

There are off-site activities possible as well such as boat cruises and bike tours.

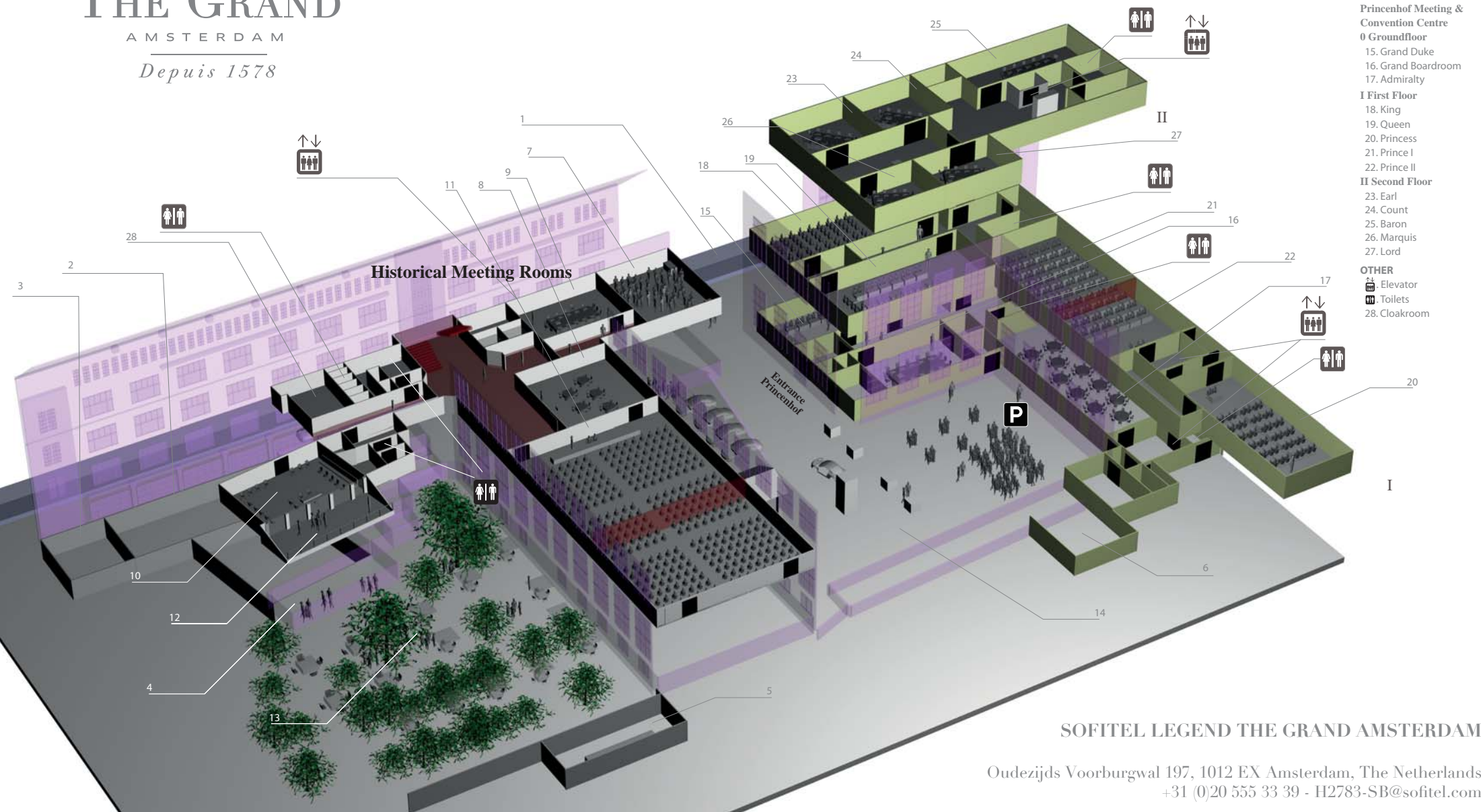


HOTEL THE GRAND

AMSTERDAM

Depuis 1578

Princenhof Meeting & Convention Centre



- 1. Entrance
- 2. Restaurant Bridges*
- 3. Private dining
- 4. Le Petit Bistro
- 5. The Flying Dutchman
- 6. The Floral Shop

II Historical Meeting Rooms

- 7. Alderman's Chamber
- 8. St. Cecilia Chamber
- 9. Burgomaster's Chamber
- 10. Marriage Chamber
- 11. Council Chamber
- 12. Balcony
- 13. Garden Terrace
- 14. Courtyard

Princenhof Meeting & Convention Centre

0 Groundfloor

- 15. Grand Duke
- 16. Grand Boardroom
- 17. Admiralty

I First Floor

- 18. King
- 19. Queen
- 20. Princess
- 21. Prince I
- 22. Prince II

II Second Floor

- 23. Earl
- 24. Count
- 25. Baron
- 26. Marquis
- 27. Lord

OTHER

- Elevator
- Toilets
- 28. Cloakroom

SOFITEL LEGEND THE GRAND AMSTERDAM










Oudezijds Voorburgwal 197, 1012 EX Amsterdam, The Netherlands
+31 (0)20 555 33 39 - H2783-SB@sofitel.com

Capacity Inspired Meetings Rooms

All rooms have airconditioning / aircooling, no pilars and natural daylight!



HOTEL
THE GRAND
AMSTERDAM
Depuis 1578

	L	W	H	M ²	Ft ²	 Theatre	 Cabaret/ Crescent PHS -5 pax/table	 Cabaret/ Crescent HS -5,6,7 pax/table	 Classroom	 Square	 U-shape	 Boardroom	 Banquet	 Cocktail
Council Chamber	21,7	13,6	4,7	295	3175	320	-	133	140	-	-	-	200	300
* Council Chamber I	13,6	13,0	4,7	177	1905	200	-	77	72	48	36	36	110	175
* Council Chamber II	14,0	8,7	4,2	122	1313	120	-	56	45	32	23	24	90	125
St. Cecilia Chamber	8,0	7,5	5,0	60	645	50	-	21	27	32	24	20	30 ⁺ /40	60
Aldermans Chamber	8,1	7,0	3,0	57	613	40	-	21	24	24	24	20	30 ⁺ /40	60
Burgomaster Chamber	8,2	5,3	3,0	43	462	30	-	-	18	-	-	20	20 ⁺ /30	40
Marriage Chamber	8,0	6,4	3,2	51	548	45	-	-	-	-	-	18* / 20	20	40
* Balcony	8,0	6,4	3,2	51	548	-	-	-	-	-	-	-	-	25
Admiralty	19,0	7,6	3,7	144	1550	110	56	-	-	-	-	-	80 ⁺ /100	150
Grand Boardroom	9,7	5,8	4,2	56	602	FIXED BOARDROOM			-	-	-	18	MAXIMUM CAPACITY	
Grand Duke	6,7	5,9	3,6	39	419	30	14	-	12	16	12	12	20	30
Prince	19,4	8,0	3,3	155	1668	150*	75	-	72	54	46	40	70 ⁺ /80	150
* Prince I	11,4	8,0	3,3	91	979	100*	45	-	45	36	32	30	50	90
* Prince II	8,0	8,0	3,3	64	688	50*	30	-	27	24	16	14	30	60
Queen	13,8	6,2	3,2	85	914	80	30	-	30	26	32	28	40 ⁺ /48	100
King	15,2	6,2	3,8	94	1011	80	30	-	30	26	32	28	40 ⁺ /48	100
Princess	17,4	6,0	2,8	104	1119	80	30	-	30	26	28	28	-	100
Lord	7,2	5,9	2,7	42	452	FIXED BOARDROOM			-	-	-	16+ / 14#	MAXIMUM CAPACITY	
Marquis	6,0	4,7	2,7	28	301	FIXED BOARDROOM			-	-	-	10+ / 8#	MAXIMUM CAPACITY	
Earl	6,0	4,7	2,8	28	301	FIXED BOARDROOM			-	-	-	8+ / 5#	MAXIMUM CAPACITY	
Count	6,5	5,9	2,8	38	409	FIXED BOARDROOM			-	-	-	16+ / 14#	MAXIMUM CAPACITY	
Baron (+ small seating, not incl.)	9,5	4,6	2,8	43	462	FIXED BOARDROOM			-	-	-	12+ / 10#	MAXIMUM CAPACITY	
Foyer I	6,5	3,4	3,8	22	236	-	-	-	-	-	-	-	-	20
Foyer II	6,0	3,5	2,8	21	226	-	-	-	-	-	-	-	-	20

All figures based on new furniture, safety regulations

* Without stage

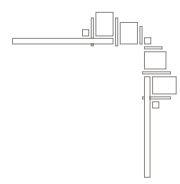
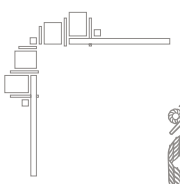
* oval table
+ without screen
with screen
+ with buffet

Please note: In Princenhof set-ups will only be done with new furniture

Cabaret and Crescent set-ups will be done with chairs without arm support with a maximum of 7 pax per table

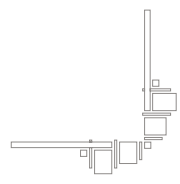
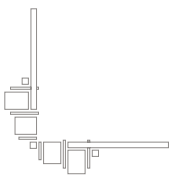
Classroom set-ups will be done with chairs without arm support and a maximum of 3 pax per table

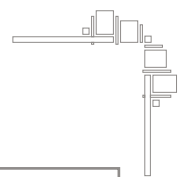
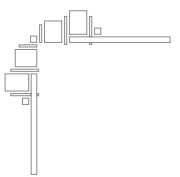
Boardroom, U-shape and Square set-ups will be done with chairs with arm support and a maximum of 2 pax per table



HOTEL
THE GRAND
 AMSTERDAM
Depuis 1578

Historical Rooms First Floor










Main Building - First Floor

Marriage Chamber

The Marriage Chamber is located on the first floor of the monumental wing of the hotel and designed by Chris LeBeau, which he completed in 1926.

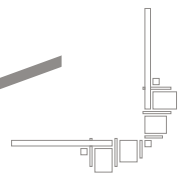
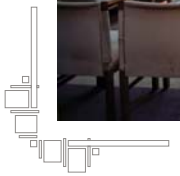
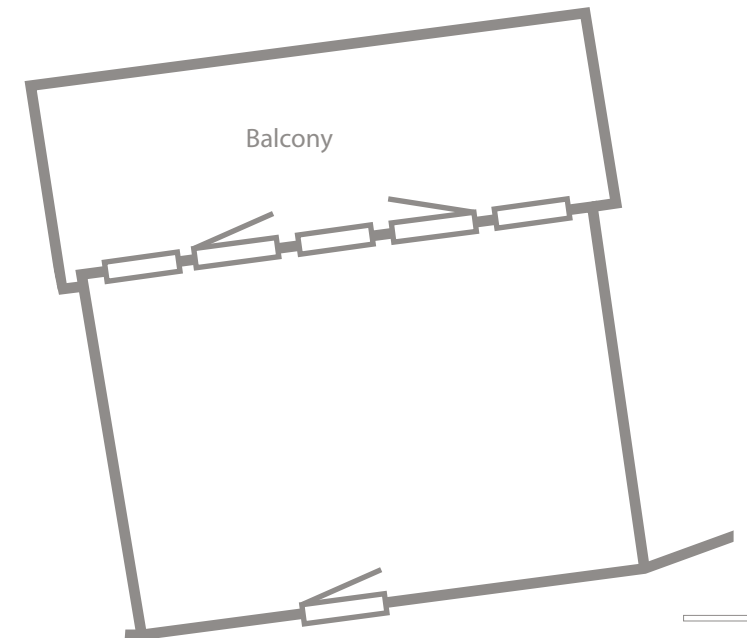
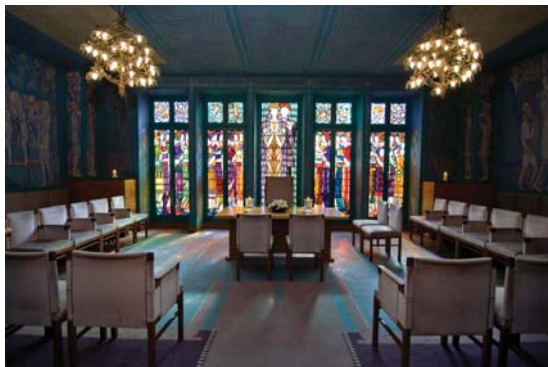
The unique colors, wonderful paintings and history, with the view of the garden and balcony provide an elegant setting with a harmonious ode to marriage and love.

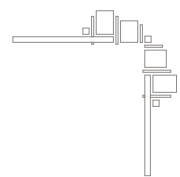
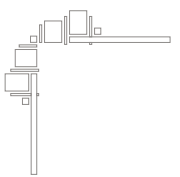
- Stained glass windows which can be opened
- Adjoining Balcony (24sqm)
- Air-conditioned

DIMENSIONS MARRIAGE CHAMBER							
surface (m ²)/ft ²		length (m)		width (m)		height (m)	
51 / 548		8.0		6.4		3.2	
CAPACITY MARRIAGE CHAMBER				BALCONY			
 banquet	20	 boardroom	18*/20	 cocktail	25		
 theatre	45	 cocktail	40				

* oval table

Photo credits: Kaan Sensoy





Main Building - First Floor

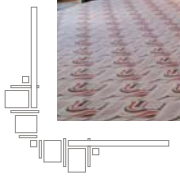
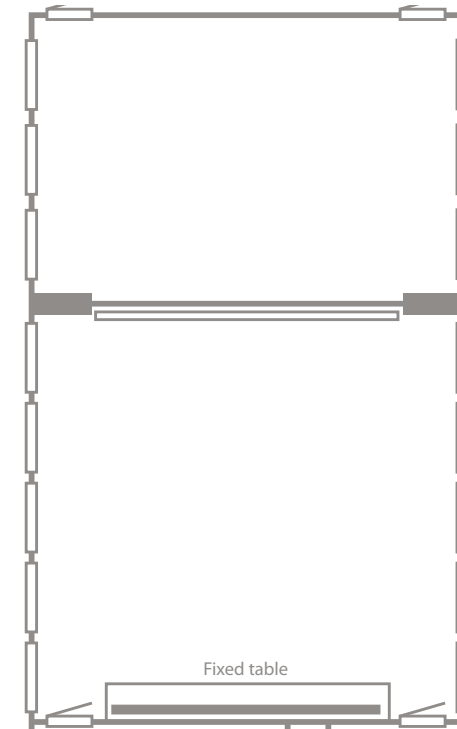
Council Chamber

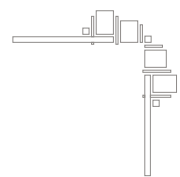
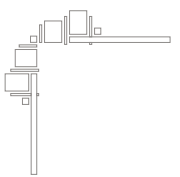
The Council Chamber was built in 1924 as the headquarters for Amsterdam's city council. Listed as a historic monument, in the room is notable for its painted, engraved and carved wood panels. In this setting Her Majesty Queen Beatrix of the Netherlands got married in 1966.

- Build in projection screen of 5,9m * 3,4m
- Natural Daylight
- Adjustable lightning and blinds
- Air-conditioned and windows that can be opened
- Fixed council table in front of the screen



DIMENSIONS					
surface (m ²)/ft ²	length (m)	width (m)	height (m)		
295 / 3175	21.7	13.6	4.7		
CAPACITY					
theatre	320	classroom	140	cocktail	300
banquet	200	crescent	133		













Main Building - First Floor

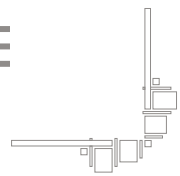
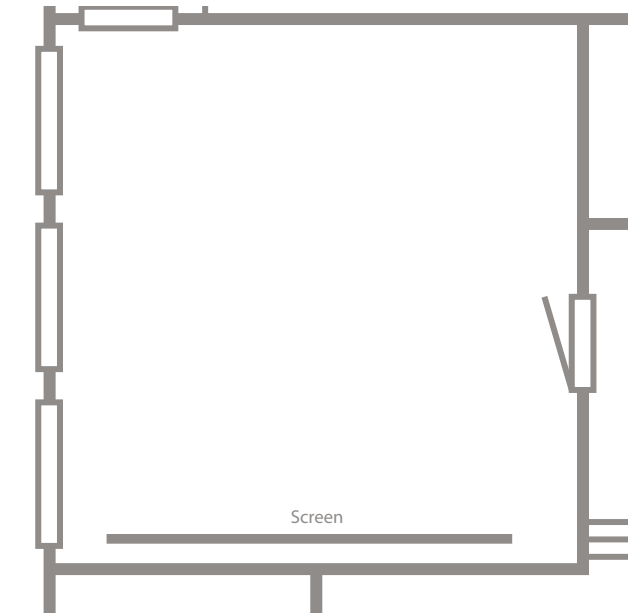
St. Cecilia Chamber

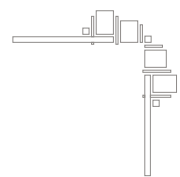
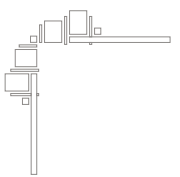
The St. Cecilia Chamber is one of the historical meeting rooms, located on the first floor and is overlooking the courtyard of Sofitel Legend The Grand Amsterdam. It was used as one of the previous offices of the former city hall of Amsterdam. This square shaped historical meeting room is located right next to the Council Chamber and has remarkable high ceilings.

- *Build in projection screen of 2,4m* 1,75m*
- *Natural Daylight*
- *Adjustable lightning and blinds*
- *Air-conditioned and windows that can be opened*

DIMENSIONS							
surface (m ²)/ft ²		length (m)		width (m)		height (m)	
60 / 645		8.0		7.5		5.0	
CAPACITY							
 theatre	50	 square	32	 classroom	27		
 U-shape	24	 boardroom	20	 cocktail	60		
 banquet	30+/40	 crescent	21				

+ with buffet





Main Building - First Floor

Aldermans Chamber

The historical Aldermans Chamber is a stunning room and has been used – up until 1992 – as the Mayor’s meeting office. Besides this unique role in Amsterdam’s history, the room offers you a spectacular view over the oldest canal in Amsterdam and its iconic canal houses.

- *Build in projection screen of 2,4m* 1,75m*
- *Natural Daylight*
- *Adjustable lightning*
- *Air-conditioned (and windows that can be opened)*

Photo credits: Kaan Sensoy

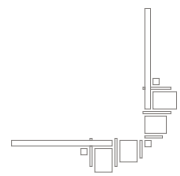
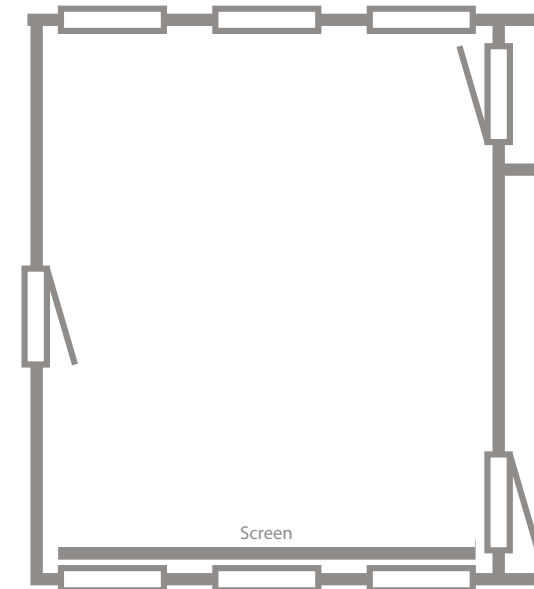


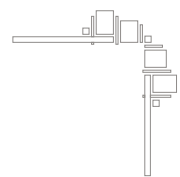
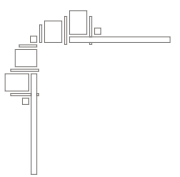
Photo credits: Kaan Sensoy



DIMENSIONS					
surface (m ²)/ft ²	length (m)	width (m)	height (m)		
57 / 613	8.1	7.0	3.0		
CAPACITY					
theatre	40	square	24	classroom	24
U-shape	24	boardroom	20	cocktail	60
banquet	30+/40	crescent	21		

+ with buffet










Main Building - First Floor

Burgomaster Chamber

The Burgomaster Chamber has been used up until 1992 by the former mayor of Amsterdam. Through the large windows, the view is simply stunning; overlooking our capital's oldest canal, including the iconic Amsterdam canal houses. This will definitely ensure a lasting experience for your guests!

- *Build in projection screen of 2,4m* 1,75m*
- *Natural Daylight*
- *Adjustable lightning*
- *Air-conditioned (and windows that can be opened)*

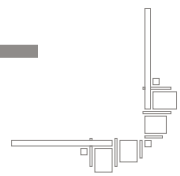
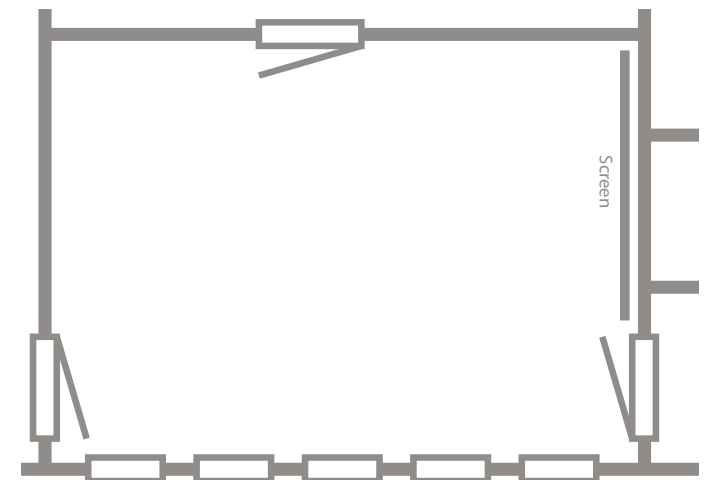
DIMENSIONS							
surface (m ²)/ft ²		length (m)		width (m)		height (m)	
43 / 462		8.2		5.3		3.0	
CAPACITY							
 theatre	30	 classroom	18	 cocktail	40		
 banquet	20+/30	 boardroom	20				

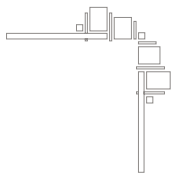
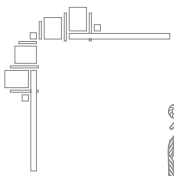
+ with buffet

Photo credits: Kaan Sensoy

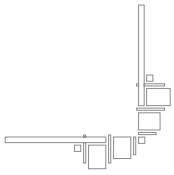
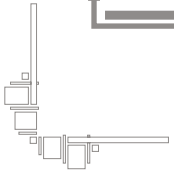
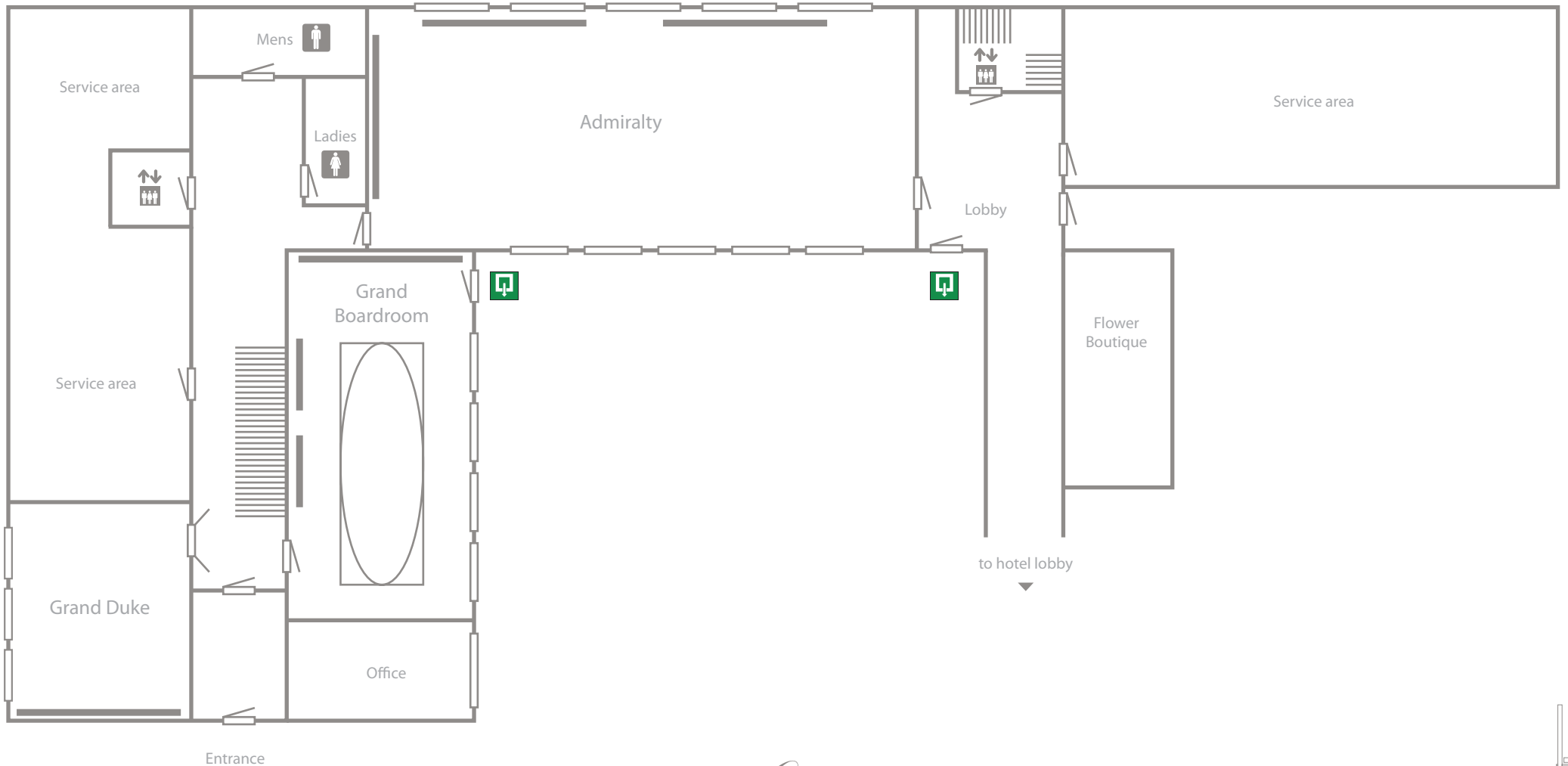


Photo credits: Kaan Sensoy





Princenhof Ground Floor








Princenhof - Ground Floor

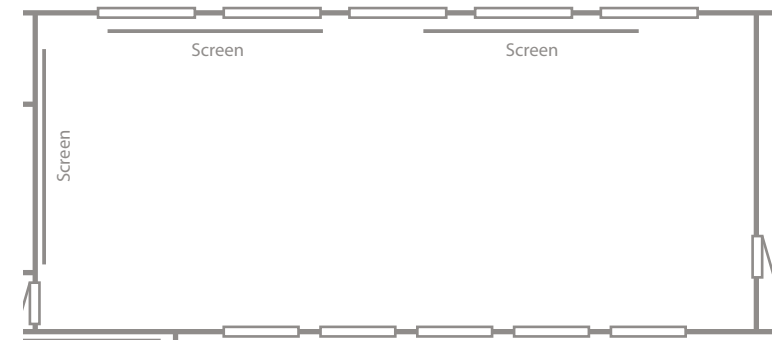
Admiralty

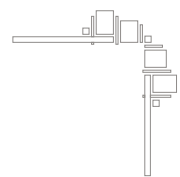
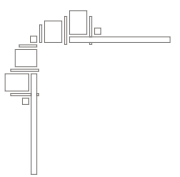
The Admiralty is located on the ground floor of the Princenhof. It displays a stylish palette of grey and pink colors. This beautiful room with high windows, overlooks the courtyard and hotel façade. During summer the Admiralty is ideal to combine with the Courtyard.

- 3 build in projectors and projection screens of 2,4m* 1,75m
- Build in Audio System
- Natural Daylight
- Adjustable lightning and blinds
- Air-conditioned

DIMENSIONS							
surface (m ²)/ft ²		length (m)		width (m)		height (m)	
144 / 1550		19.0		7.6		3.7	
CAPACITY							
 theatre	110	 boardroom	40	 cocktail	150*		
 banquet	80+ 100	 crescent	56	* without stage / buffet + with stage / buffet			

+ with buffet






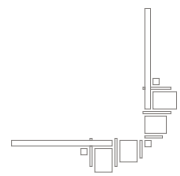
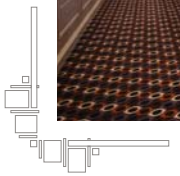
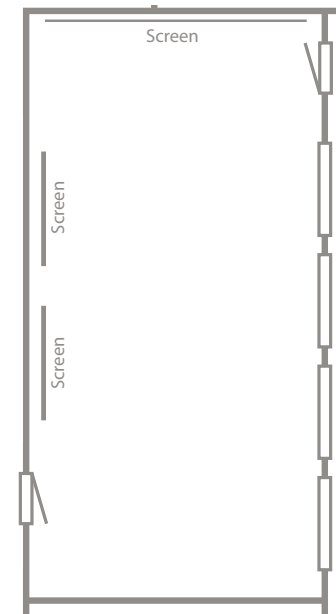
Princenhof - Ground Floor

Grand Boardroom

The Grand Boardroom is a state of the art meeting facility that is equipped with the latest technology, such as video conference and build in Audio Visual equipment. The spacious Grand Boardroom overlooks the historical courtyard and may be combined with the Grand Duke as a private catering location.

- *Build in projection screen of 2,4m* 1,75m*
- *2 extra projection screens*
- *Natural Daylight*
- *Adjustable lightning and blinds*
- *Air-conditioned and windows that can be opened*
- *Power socket, VGA and internet access integrated in table*
- *Soundproof*

DIMENSIONS			
surface (m ²)/ft ²	length (m)	width (m)	height (m)
56 / 602	9.7	5.8	4.2
CAPACITY			
 boardroom		18	











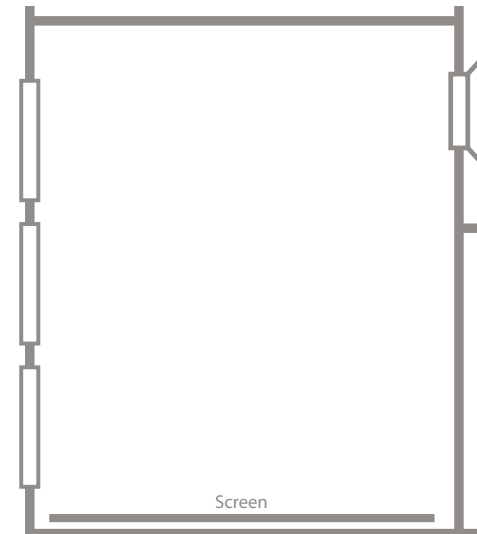
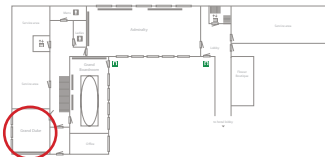
Princenhof - Ground Floor

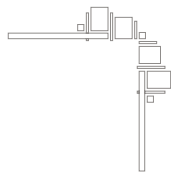
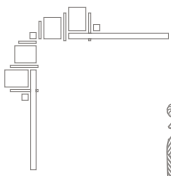
The Grand Duke

The Grand Duke is located on the ground floor next to the imposing entrance of the Princenhof. The room has natural daylight and overlooks one of Amsterdam's most beautiful canals and typical Dutch houses.

- *Build in projector and projection screen of 2,4m* 1,75m*
- *Build in Audio System*
- *Natural Daylight*
- *Adjustable lightning and curtains*
- *Air-conditioned*

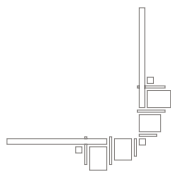
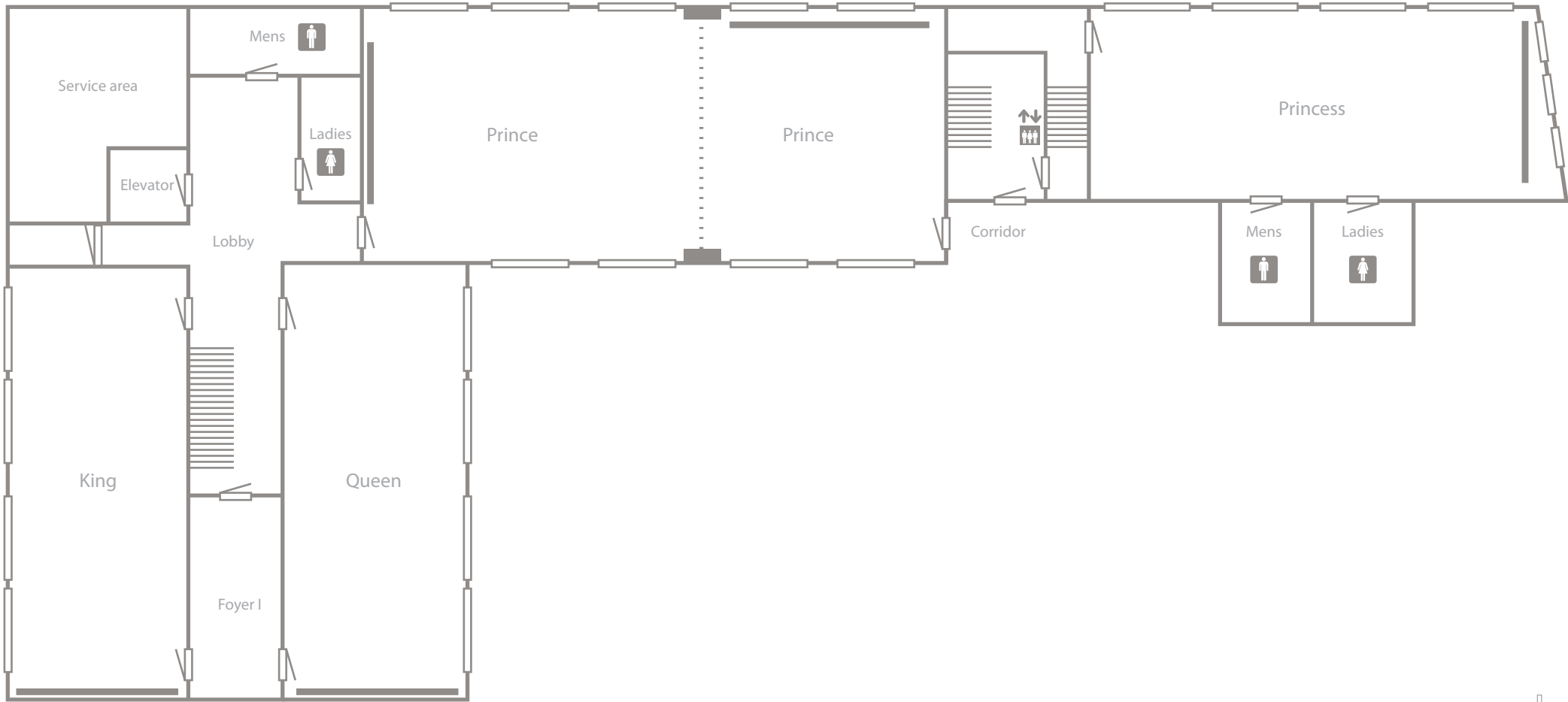
DIMENSIONS							
surface (m ²)/ft ²		length (m)		width (m)		height (m)	
39 / 419		6.7		5.9		3.6	
CAPACITY							
 theatre	30	 square	16	 classroom	12		
 U-shape	12	 boardroom	12	 cocktail	30		
 banquet	20	 crescent	14				

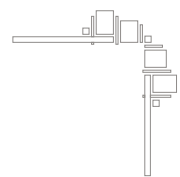
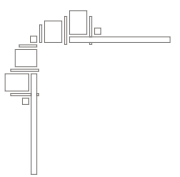




HOTEL
THE GRAND
 AMSTERDAM
Depuis 1578

Princenhof First Floor













Princenhof - First Floor

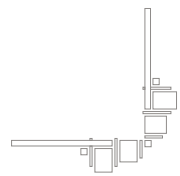
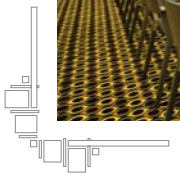
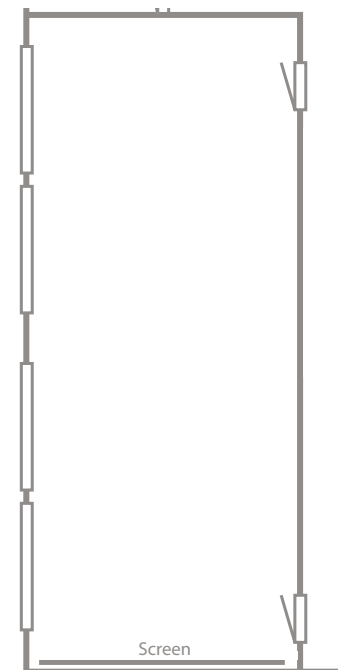
King

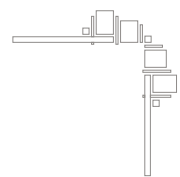
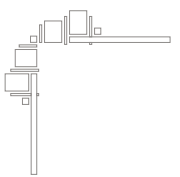
The King room is based on the first floor of the Princenhof. It is the exact opposite of the Queen room separated by a Foyer. The King room has natural daylight combined with a unique view over the Amsterdam canals.

- Build in projector and projection screen of 3,00m* 2,25m
- Build in Audio System
- Natural Daylight
- Adjustable lightning and blinds
- Air-conditioned

DIMENSIONS							
surface (m ²)/ft ²		length (m)		width (m)		height (m)	
94 / 1011		15.2		6.2		3.8	
CAPACITY							
 theatre	80	 square	26	 cocktail	100		
 U-shape	32	 boardroom	28	 cabaret (5 pax/table)	30		
 banquet	40+/48	 classroom	30				

+ with buffet













Princenhof - First Floor

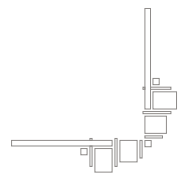
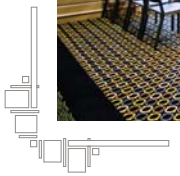
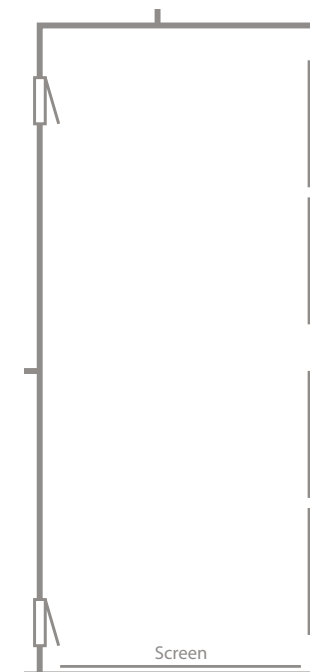
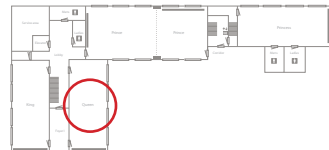
Queen

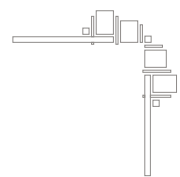
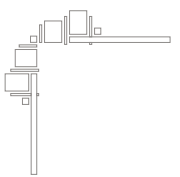
The Queen room is based on the first floor of the Princenhof. The room can be combined with a private Foyer or office area. The Queen room has loads of natural daylight combined with a view over the courtyard.

- Build in projector and projection screen of 3,00m* 2,25m
- Build in Audio System
- Natural Daylight
- Adjustable lightning and blinds
- Air-conditioned

DIMENSIONS							
surface (m ²)/ft ²		length (m)		width (m)		height (m)	
85 / 914		13.8		6.2		3.2	
CAPACITY							
 theatre	80	 square	26	 cocktail	100		
 U-shape	32	 boardroom	28	 cabaret (5 pax/table)	30		
 banquet	40+ 48	 classroom	30				

+ with buffet












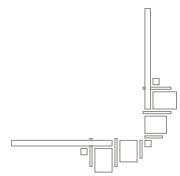
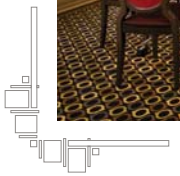
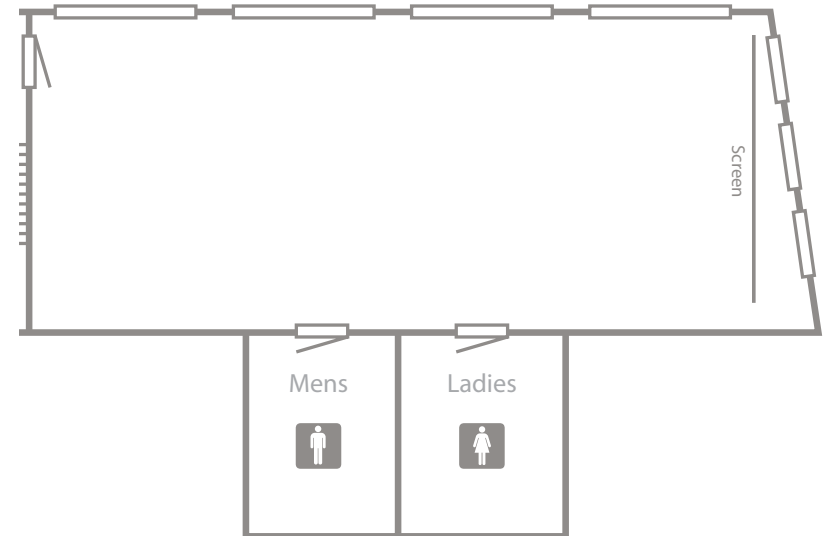
Princenhof - First Floor

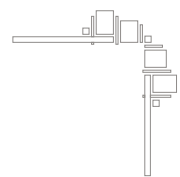
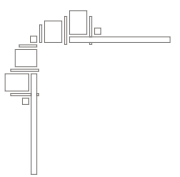
Princess

The Princess is based on the first floor of the Princenhof. The room is equipped with all the modern comforts and has private bathroom facilities. This Princess is overlooking the Amsterdam canals and has large windows on two sides of the room which makes it a very light room.

- *Build in projector and projection screen of 2,90m* 1,8m*
- *Build in Audio System*
- *Natural Daylight*
- *Adjustable lightning and blinds*
- *Air-conditioned*

DIMENSIONS							
surface (m ²)/ft ²		length (m)		width (m)		height (m)	
104 / 1119		17.4		6.0		2.8	
CAPACITY							
 theatre	80	 square	26	 classroom	30		
 U-shape	28	 boardroom	28	 cocktail	100		
		 cabaret (5 pax/table)	30				













Princenhof - First Floor

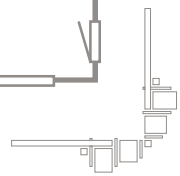
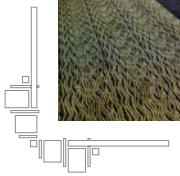
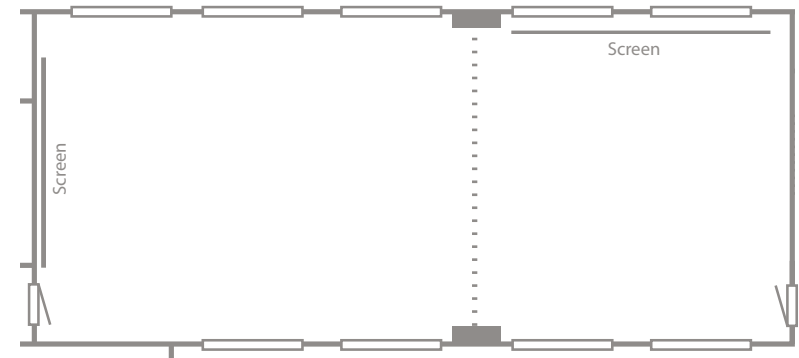
Prince

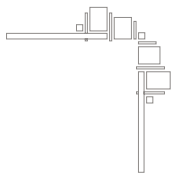
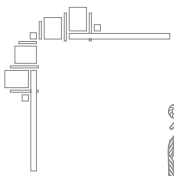
The Prince room is situated on the first floor of the Princenhof. All the Audio-Visual is build in to increase the level of comfort. The Prince overlooks the hotels courtyard and the typical Amsterdam Canal Houses. The Prince room can be divided by a sliding wall, Prince I has a total of 90.4 square meters and the Prince II a total of 64.6 square meters.

- Build in projector and projection screen of 4,00m* 2,24m
- Build in Audio System
- Natural Daylight
- Adjustable lightning and blinds
- Air-conditioned

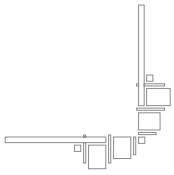
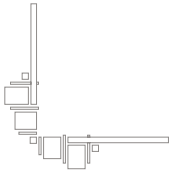
DIMENSIONS							
surface (m ²)/ft ²		length (m)		width (m)		height (m)	
155 / 1668		19.4		8.0		3.3	
CAPACITY							
 theatre	150*	 square	54	 classroom	72		
 U-shape	46	 boardroom	40	 cocktail	150*		
 banquet	70+ / 80	 cabaret (5 pax/table)	75				

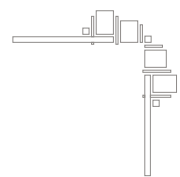
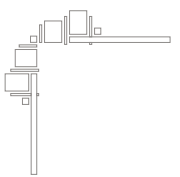
* without stage
+ with buffet





Princenhof Second Floor






Princenhof - Second Floor

Earl

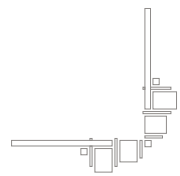
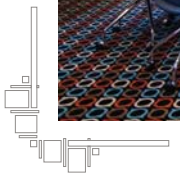
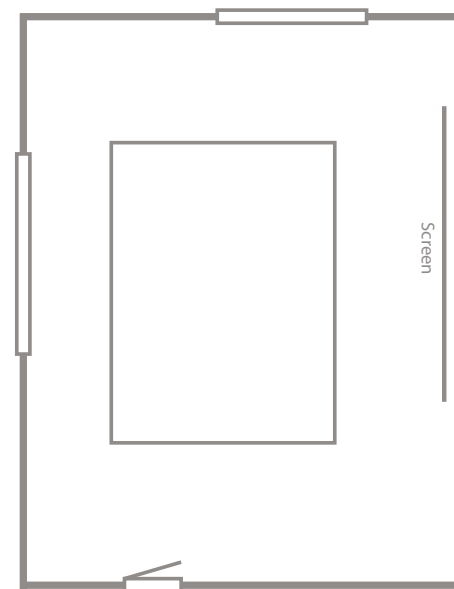
The Earl is a fixed boardroom on the second floor of the Princenhof. The room has a central control panel that enables guests to control the room. The room can easily be combined with the other boardrooms on the floor.

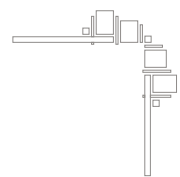
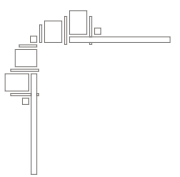
- *Build in 52" HD plasma screen*
- *Natural Daylight*
- *Adjustable lightning and curtains*
- *Air-conditioned*
- *Power socket, VGA and internet access integrated in table*

DIMENSIONS			
surface (m ²)/ft ²	length (m)	width (m)	height (m)
28 / 301	6.0	4.7	2.8

CAPACITY	
 boardroom	8+ / 5 [#]

+ without screen
with screen






Princenhof - Second Floor

Count

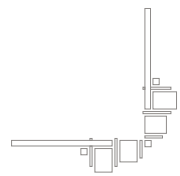
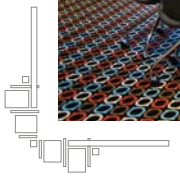
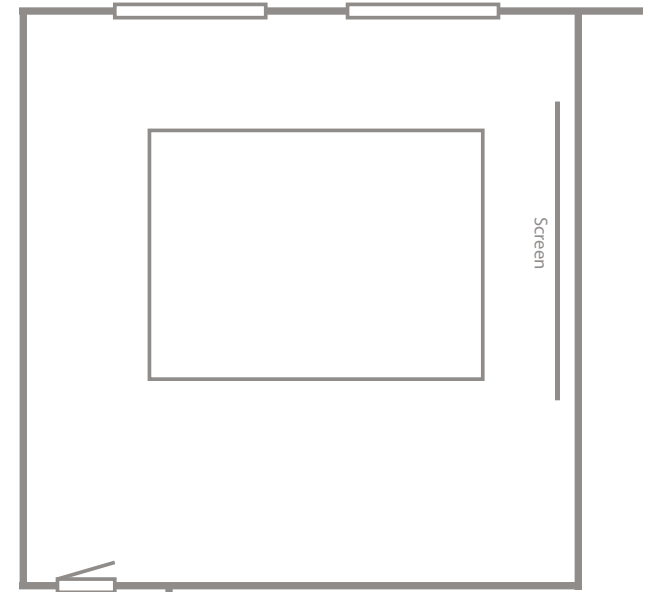
The Count is a fixed boardroom on the second floor of the Princenhof. The room has a central control panel that enables guests to control the room. The room can easily be combined with the other boardrooms on the floor.

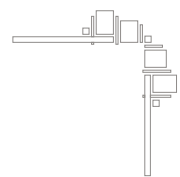
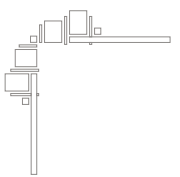
- *Build in 65" HD plasma screen*
- *Natural Daylight*
- *Adjustable lightning*
- *Air-conditioned*
- *Power socket, VGA and internet access integrated in table*

DIMENSIONS			
surface (m ²)/ft ²	length (m)	width (m)	height (m)
38 / 409	6.5	5.9	2.8

CAPACITY	
 boardroom	16+ / 14#

+ without screen
with screen






Princenhof - Second Floor

Baron

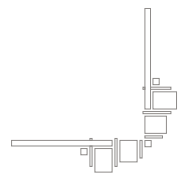
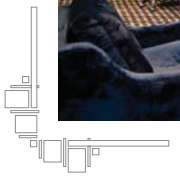
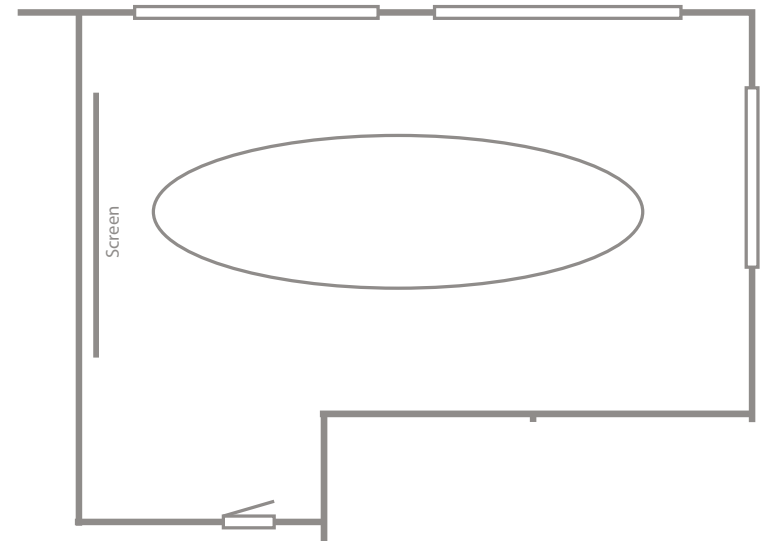
The Baron is a fixed boardroom on the second floor of the Princenhof. The room has a comfortable lounge area next to the boardroom table.

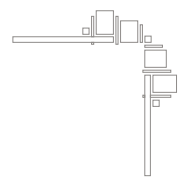
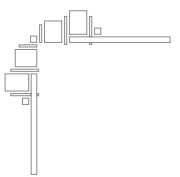
- *Build in projector and projection screen of 2,4m* 1,75m*
- *Natural Daylight*
- *Adjustable lightning*
- *Air-conditioned*
- *Power socket, VGA and internet access integrated in table*

DIMENSIONS			
surface (m ²)/ft ²	length (m)	width (m)	height (m)
43 / 462	9.5	4.6	2.8

CAPACITY	
 boardroom	12+ / 10#

+ without screen
with screen






Princenhof - Second Floor

Marquis

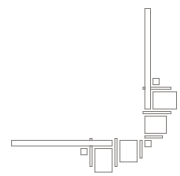
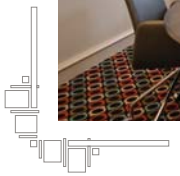
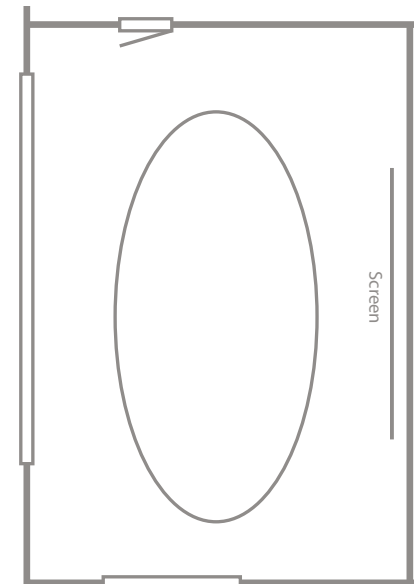
The Marquis is a fixed boardroom on the second floor of the Princenhof. The room has a central control panel that enables guests to control the room. The room can easily be combined with the other boardrooms on the floor.

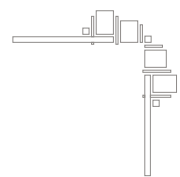
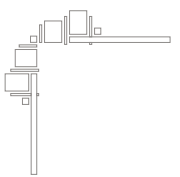
- *Build in 52" HD plasma screen*
- *Natural Daylight*
- *Adjustable lightning*
- *Air-conditioned*
- *Power socket, VGA and internet access integrated in table*

DIMENSIONS			
surface (m ²)/ft ²	length (m)	width (m)	height (m)
28 / 301	6.0	4.7	2.7

CAPACITY	
 boardroom	10+ / 8#

+ without screen
with screen






Princenhof - Second Floor

Lord

The Lord is a fixed boardroom on the second floor of the Princenhof. The room has a central control panel that enables guests to control the room. The room can easily be combined with the other boardrooms on the floor.

- *Build in 65" HD plasma screen*
- *Natural Daylight*
- *Adjustable lightning*
- *Air-conditioned*
- *Power socket, VGA and internet access integrated in table*

DIMENSIONS			
surface (m ²)/ft ²	length (m)	width (m)	height (m)
42 / 452	7.2	5.9	2.7

CAPACITY	
 boardroom	16+ / 14#

+ without screen
with screen

